

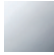





28 679 670

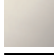

- Ausladung 450 mm
- Regenbrause Ø 300 mm
- PURE RAIN, Durchfluss max. 14 l/min (bei 3 Bar)
- Funktion ab: 10 l/min
- Rosette 65 x 65 mm
- Anschluss 1/2"
- mit Antikalk-System
- mit Leerlauf-Funktion

| | | |
|---|----------------------------------|---------------|
|  | Chrom gebürstet | 28 679 670-93 |
|  | Chrom | 28 679 670-00 |
|  | Platin gebürstet | 28 679 670-06 |
|  | Platin | 28 679 670-08 |
|  | Messing gebürstet (23kt Gold) | 28 679 670-28 |
|  | Schwarz matt | 28 679 670-33 |
|  | Dark Platinum gebürstet | 28 679 670-99 |

Empfohlenes Zubehör

UP-Wandwinkel - 35 085 970 90



- Max. Einbautiefe 163 mm
- Min. Einbautiefe 90 mm

28 679 670

mm [inches]

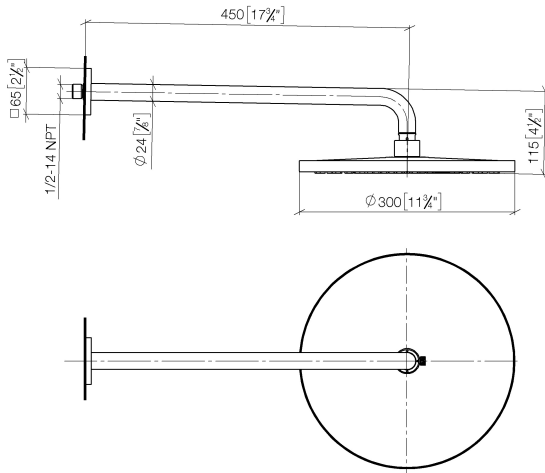

Durchflussdiagramm

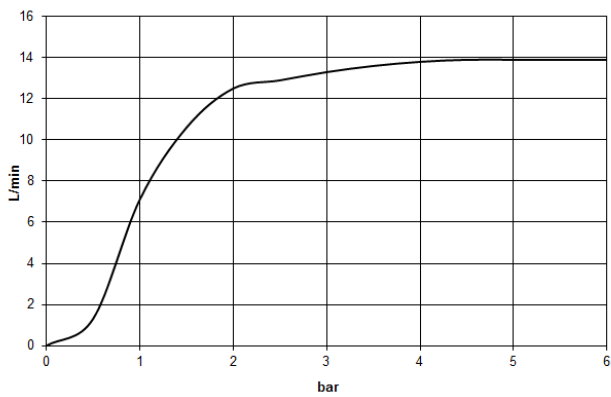

Zertifikate

WRAS_2212012. LGA_29235.

28 679 670

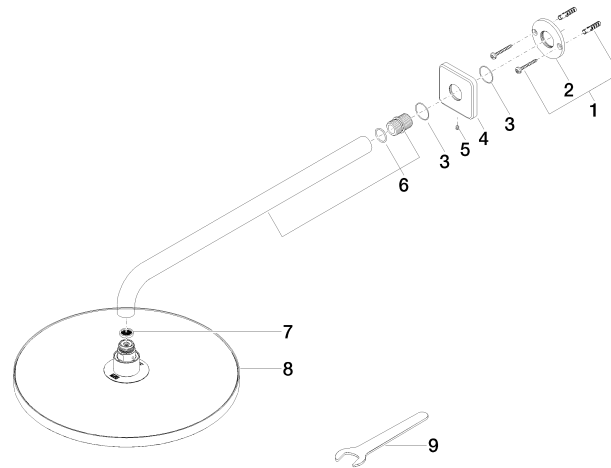

Ersatzteilstückliste

| Nr. | Artikelnummer | Benennung | Verbaumenge | Lieferzeit |
|-----|--------------------|------------------|-------------|------------|
| 1 | 04 30 31 032 00 90 | Befestigungssatz | 1 | 2 |
| 2 | 09 17 20 120 90 | Halter | 1 | 2 |
| 3 | 09 14 10 150 90 | Dichtung | 2 | 2 |
| 4 | 09 27 67 015-93 | Rosette | 1 | 20 |
| 5 | 90 31 11 038 00 90 | Stift | 1 | 2 |
| 6 | 90 11 03 070 00-93 | Rohr | 1 | 20 |
| 7 | 09 23 01 075 90 | Einsatz | 1 | 2 |
| 8 | 04 12 05 091 00-93 | Brause | 1 | 20 |
| 9 | 90 30 09 069 00 90 | Schlüssel | 1 | 2 |